

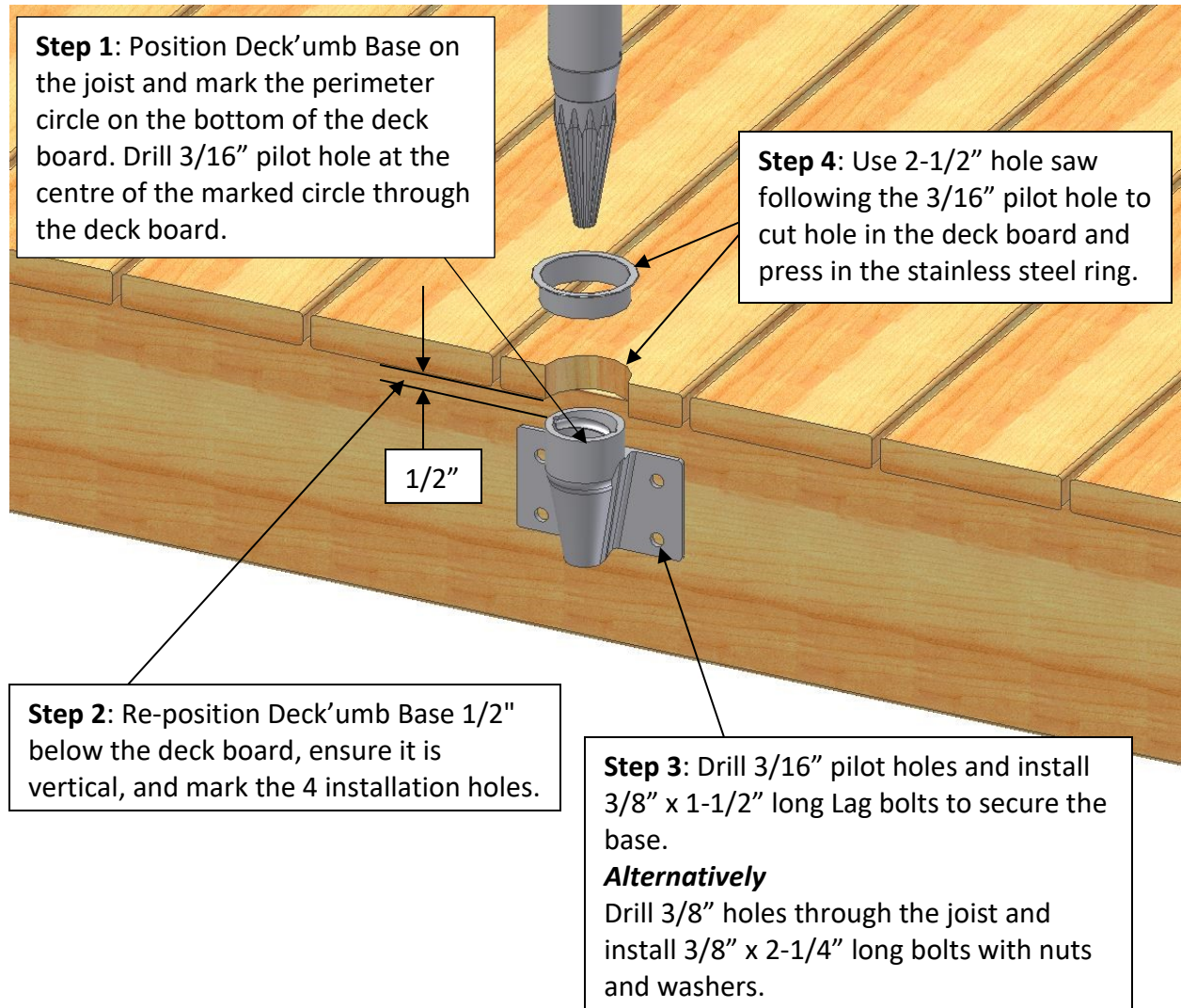

## Installation Guide

### Tools & Hardware Required:

- 3/16" drill bit and 3/8" x 1-1/2" lag bolts (4 bolts required).  
*Or* 3/8" drill bit and 3/8" x 2-1/4" bolts with nuts & washers (4 sets required).
- 2-1/2" hole saw.
- 9/16" wrench or socket wrench.



**Step 5:** Insert Deck'umb holder and line up the pin with the slot openings. Rotate the holder clockwise until it stops and then rotate counter-clockwise to lock it in the base.

**Step 6:** Insert the umbrella pole into the holder and tighten the knob to secure the umbrella.

### Removal

**Step 7:** To remove the holder from the base, rotate the holder clockwise until it stops. Then rotate it counter-clockwise and lift at the same time to disengage the holder from the base. Insert the supplied plastic cap into the stainless steel ring to cover the hole.

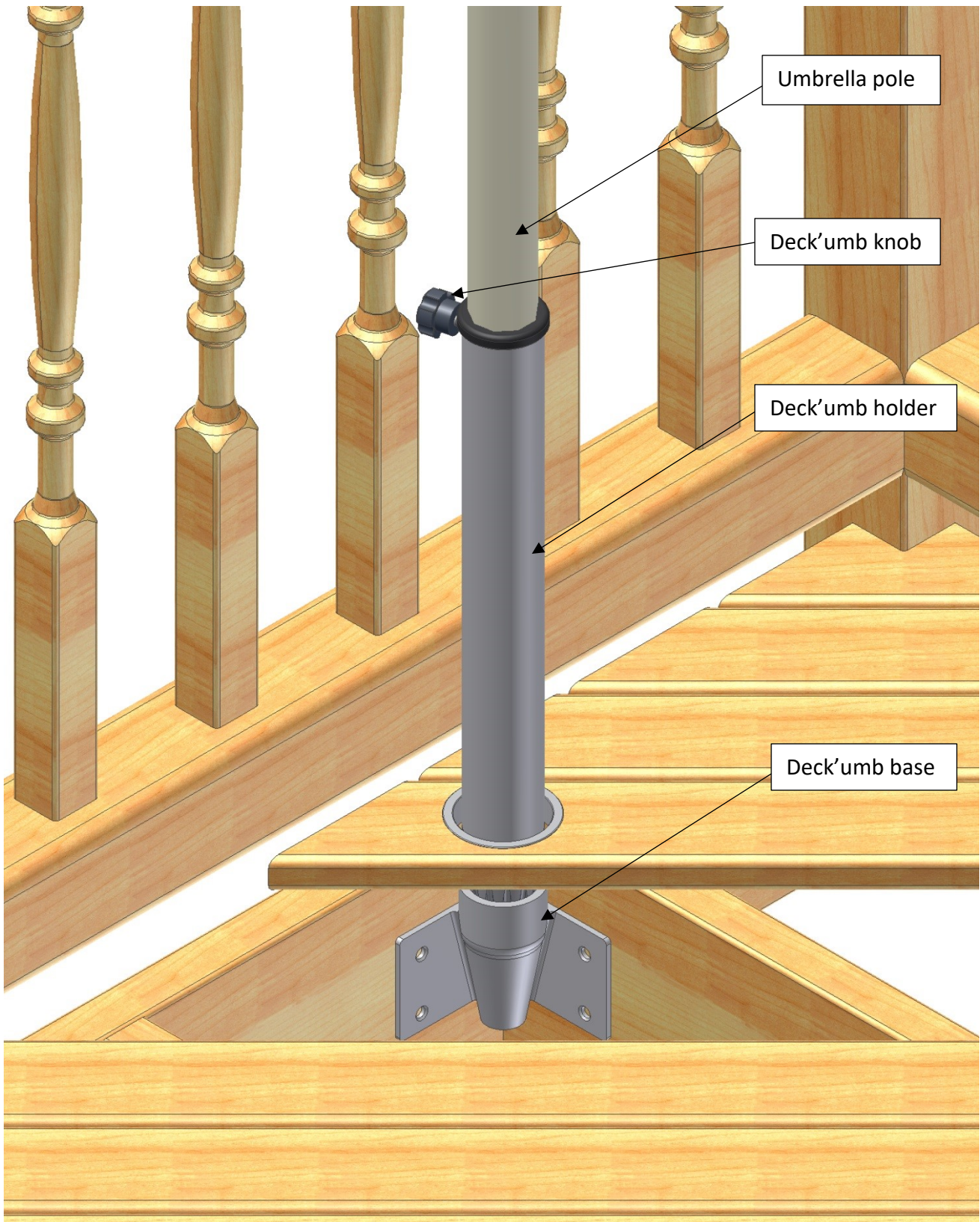

Umbrella pole

Deck'umb knob

Deck'umb holder

Deck'umb base